

Hospitality Solutions



01-02
Why HDL

03-04
Benefit from HDL hospitality solutions

Better guest experience
Higher energy efficiency
Lower management cost

05-06
A typical stay at a smart hotel

07-08
Solutions for guest rooms

09-10
What HDL does for hotel rooms

Lighting
Shading
Air-conditioning
Integration with door locks
Scene control
Control with smart speakers
Control with smart wall panels
Easy service requests and response

11-12
HDL smart software

13
Integration with PMS

14
Solutions for different types of guest rooms

23-35
Solutions for public areas

25 Lobby
26 Façade lighting
27 Café / Restaurant
28 Banquet hall
29 Spa
30 Gym
31 Recreation center / Shopping corridor
32 Conference room
33 Corridor & Stairwell
34 Garage
35 Landscape lighting

The technology behind the solutions

37	Modular Intelligent Hotel Guestroom Control System
38	RCU Intelligent Hotel Guestroom Control System
39-40	Granite Display
41-42	S10
43-44	S57
45-46	Tile
47	DLP
48	Enviro
49-50	iTouch
51-52	iElegance
53-54	Notification Stations
55-56	Ecomaster Card Switch
57	7 in 1 Sensor
58	12 in 1 Sensor
59-60	Shading Control
61	RCU
62	Room Control Host
63	22CH Mix Controller / 51 Dry Contact Module
64	I/O Module
65	4CH 0.5A Universal Dimmer / 5CH High Power Relay
66	10CH / 20CH Mix Controller
67	RS232 / RS485 Gateway / Shading Control
68	750mA / 1200mA Power Supply Module
69-70	HomePlay
71-72	9 Advantages Of Our System

73-81

Case studies

75	Morpheus Hotel, Macau
76	Gevora Hotel, Dubai
77	InterContinental London
78	Park Hyatt Sydney, Australia
79	The Apurva Kempinski Resort, Indonesia
80	Dobrograd Park Hotel, Russia
81	DoubleTree by Hilton Antalya City Centre, Turkey

Why HDL



100+

Countries
and Regions

HDL is a manufacturer of comprehensive automation systems and a provider of integrated solutions for homes, commercial buildings and hotels. Our business presence can be found in about 100 countries and regions. And products have been applied to numerous projects around the globe.

In terms of smart hotels, HDL has provided multiple top hotel management companies with products or solutions, including global groups like Intercontinental, Hyatt, Hilton, Starwood, Carlson, Wyndham and Accor. Meanwhile, over 100 five-star hotels in China are using HDL products as well.

Some of the hotel brands that are using HDL product





PRE-SALES

We provide pre-sales service of technical consultancy and solution design while opinions of feasibility on projects are given to customers. Making full use of our rich experience, we are ready to solve your thorny problems, and create for you complete and unique solutions with the latest technologies.



IN-SALE SERVICE

HDL ensures you high efficiency and quality in every project, for we have strong capabilities in R&D and manufacturing, quick response for enquiry, the advantage of system integration, large engineering project experiences and comprehensive product lines as well as professional installation skills.



AFTER-SALES SERVICE

With our well-developed after-sales service system and the customer-oriented concept, your projects will always be taken good care of. And you will be free from worries.



Benefit from HDL hospitality solutions



Better Guest Experience

People always expect “a home beyond five-star” from premium hotels. To meet such an expectation, hotels can also invest in hardware apart from providing sincere, thoughtful and friendly services. With such upgraded services, the guest can enjoy home-like comfort and 100% considerate services. What could be better than such a stay?



Higher Energy Efficiency

HDL provides a reliable and efficient system to replace traditional manual operations. By using sensors, logic modules and controlling devices on the central control system, automatic control remarkably reduce the energy waste of manual features, while the users can also get energy usage report from the system to optimize resource allocation and improve energy efficiency.



Lower Management Cost

Various scenes can be programmed using timing and logic features. Hotel staff is enabled to effortlessly control lighting and other appliances and also the multiple scenes on the PC software, iPad or wall-mounted panel to increase management efficiency. On the other hand, staff can quickly and accurately respond to guest's demands.

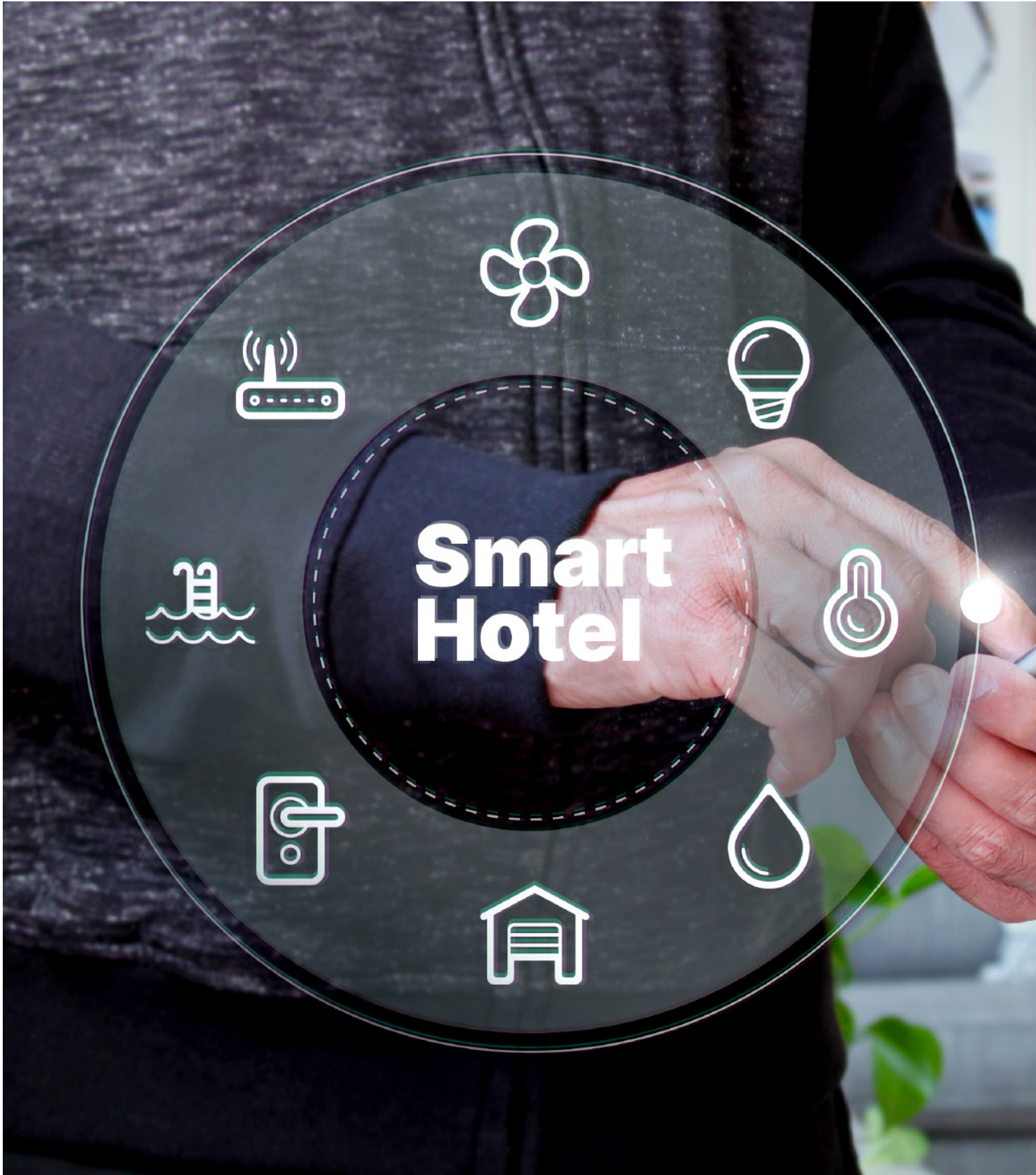

A typical stay at a smart hotel

From check-in to check-out, a hotel guest must only ever experience the very highest levels of comfort and convenience. To make this a reality, HDL has developed a range of automation solutions designed specifically for hotels. With an automated hotel, the working efficiency can also be improved so that resources can be redistributed towards a hotel's primary focus, guest satisfaction.



SOLUTIONS FOR GUEST ROOMS

At HDL we realize that each hotel is as unique as the guests who visit it. That's why every HDL installation is custom-designed to deliver a holistic solution for the individual needs of each hotel.





What HDL exactly does for hotel rooms

Lighting



HDL makes lighting control simpler and more interesting. Guest can realize the control of lighting via panels, and mobile devices and achieve multiple scenes with lighting. The system will also automatically adjust the lighting in the room with HDL lux sensors, therefore to create a pleasant atmosphere while saving energy for the hotel.

Shading



It would be annoying to get out of bed to close the curtains when getting ready for bed. With HDL guest room solutions, the guest can effortlessly control the curtains on a wall panel or mobile phone. The sound made by the curtain motor is super quiet that lower than 35dB.



Integration with door locks

Impress your guest with a Welcome Mode? HDL system can integrate with the smart door lock and the specific scene will be triggered when the guest opens the door. He/she can walk in the room with a welcome voice message and warm lights.

Air conditioning

With HDL Intelligent Hotel Management System, the receptionist can select the "Check-in" Mode for guests. The system will automatically turn on the air conditioner and keep a comfortable temperature before the guest gets into the room. And the AC will enter into "Stand-by" Mode after the guest leaves the room to save energy.



Scene control

A hotel room can preset the specific scenes for specific guests to bring thoughtful experience, for example, a romantic mode for the newlyweds, working mode for business people and so on. Guests can push one button for different modes.

Control with smart speakers

To gain more intuitive interaction with room devices. HDL hotel solutions can integrate with Amazon Alexa and Google Assistant. Guests can control all the connected room devices by speaking and sure it's available to ask Google/Alexa to play beautiful music for you.

Control with smart wall panels

Easy service requests and response

The hotel can preset various scenes on the panels, such as some common scenes like DND, MUR, Away, etc. With intelligent hotel management software, the staff can quickly receive the request of the guests and take the corresponding actions.

HDL smart hotel software

HDL Smart Hotel Software Room Management

HDL Intelligent Hotel Management System (IHMS) works with HDL's smart hotel system. It enables the hotel to manage its guest rooms, room cards, and services on a desktop computer while allowing guests to control room devices via a wall panel, mobile app or smart speaker. Therefore greatly improves work efficiency while solving customer needs in time.

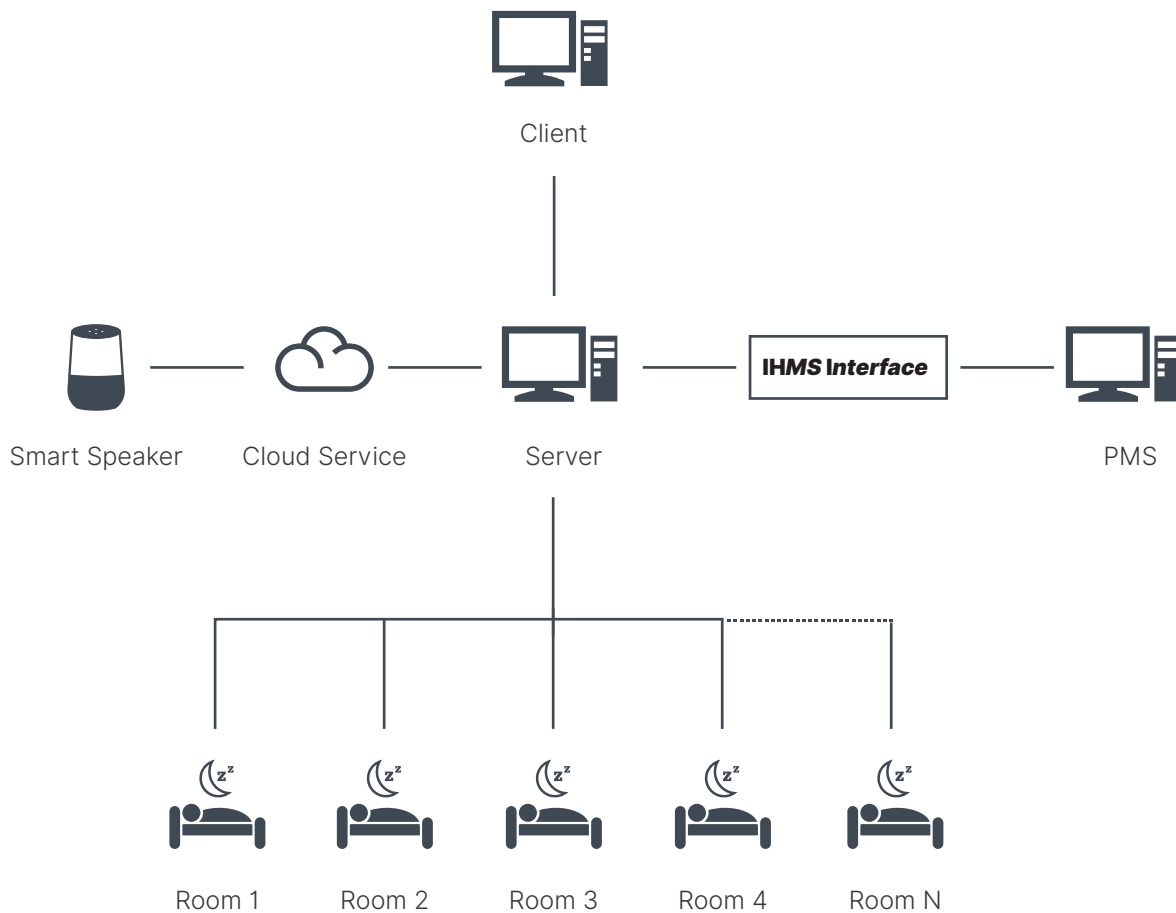

Topology of HDL Intelligent Hotel Management System

Interactive television system

The Interactive Television System is based on network transmission, and users can enjoy it through various methods such as smart TV and PC. The system is docked with the hotel PMS and RCU guest control system to integrate the hotel business. Connected to the cloud platform, it caters reservations, calls, inquiries, and all control of room services and scenes, which can be managed, operated, and upgraded on the cloud platform.



Integration with PMS

Empower your PMS system by integrating it with your HDL automation solution for an unrivaled building management platform.

Our experienced R&D team has successfully integrated Buspro into the world's most popular PMS systems. If your PMS system isn't currently compatible with Buspro, don't worry. HDL engineers are constantly working to improve Buspro compatibility and can provide a custom solution for your PMS system.

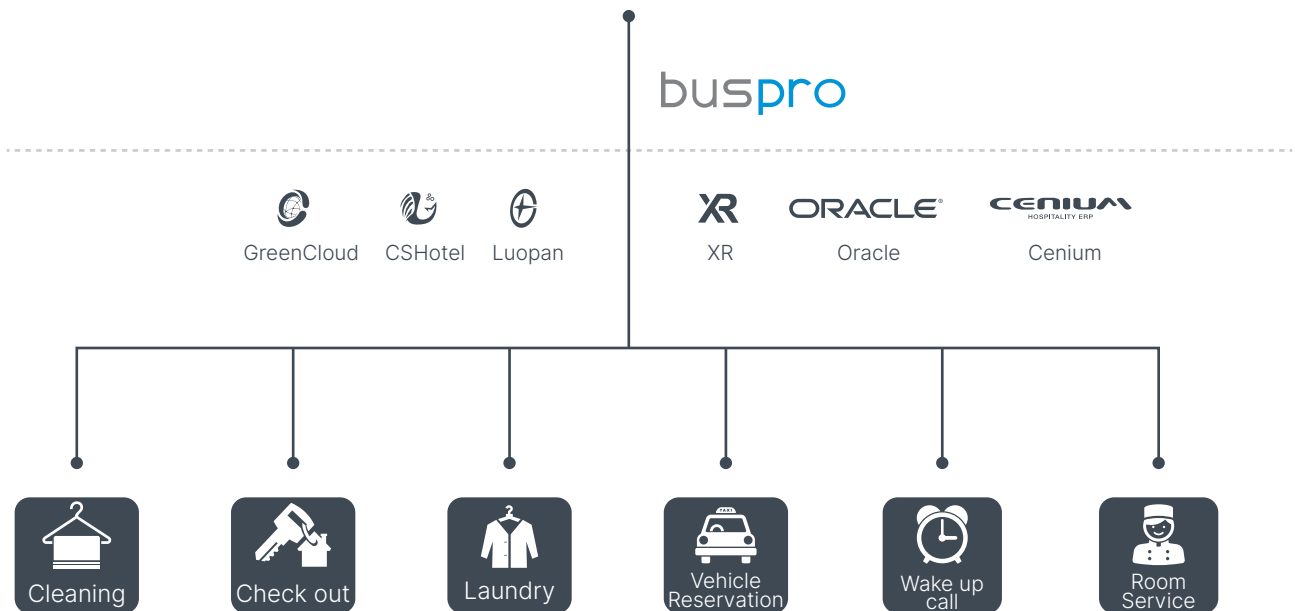
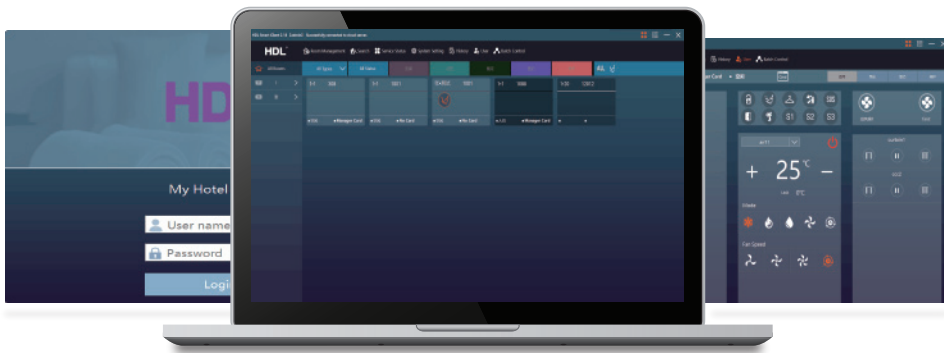



SOLUTIONS FOR DIFFERENT TYPES OF GUEST ROOMS

- Double Room
- Twin Room
- Deluxe Suite
- Presidential Suite



Double Room





Twin Room

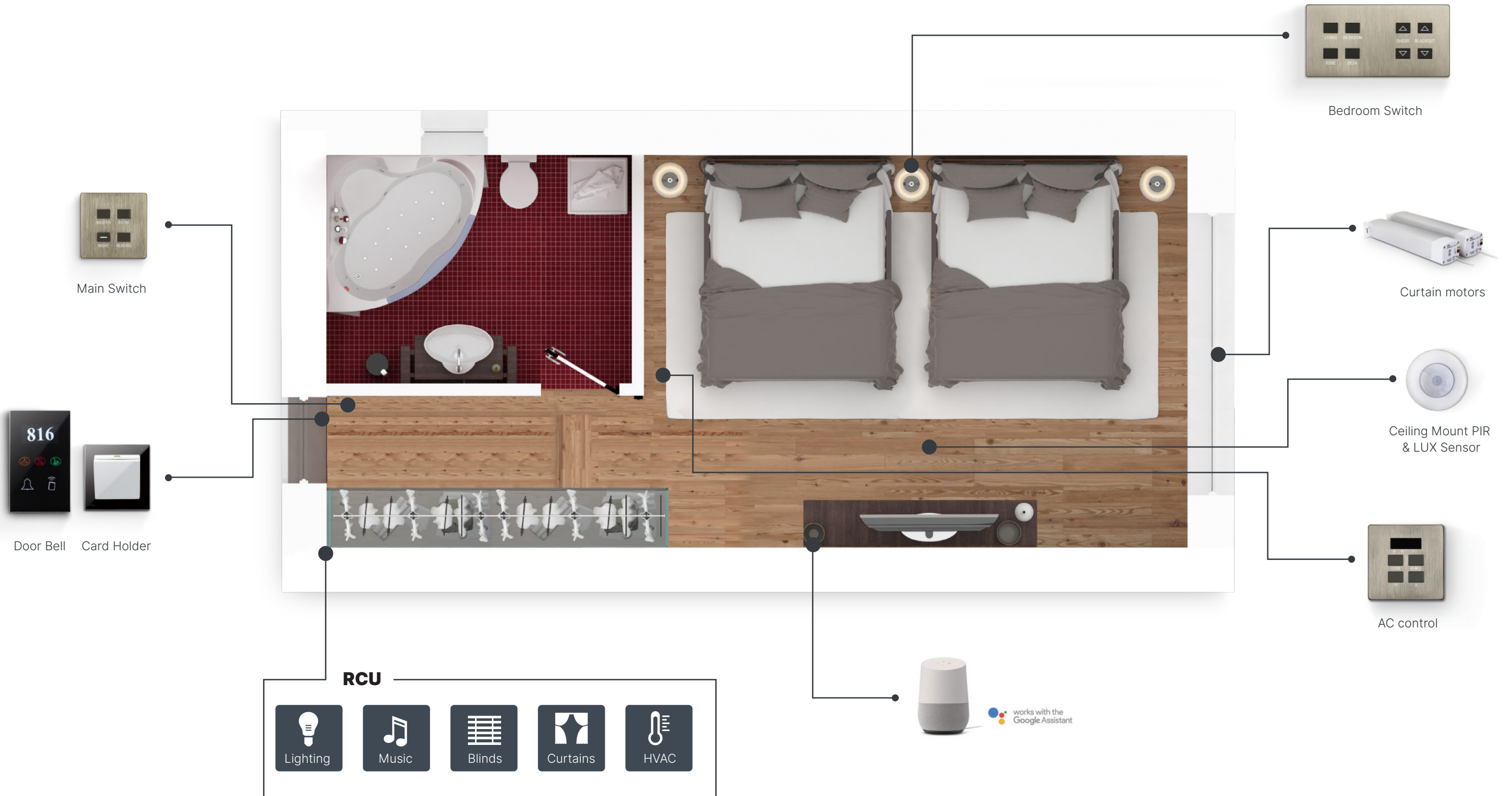

Main Switch



Door Bell



Card Holder



Bedroom Switch



Curtain motors



Ceiling Mount PIR & LUX Sensor



AC control

RCU

- Lighting
- Music
- Blinds
- Curtains
- HVAC



works with the
Google Assistant



Deluxe Suite





Presidential Suite

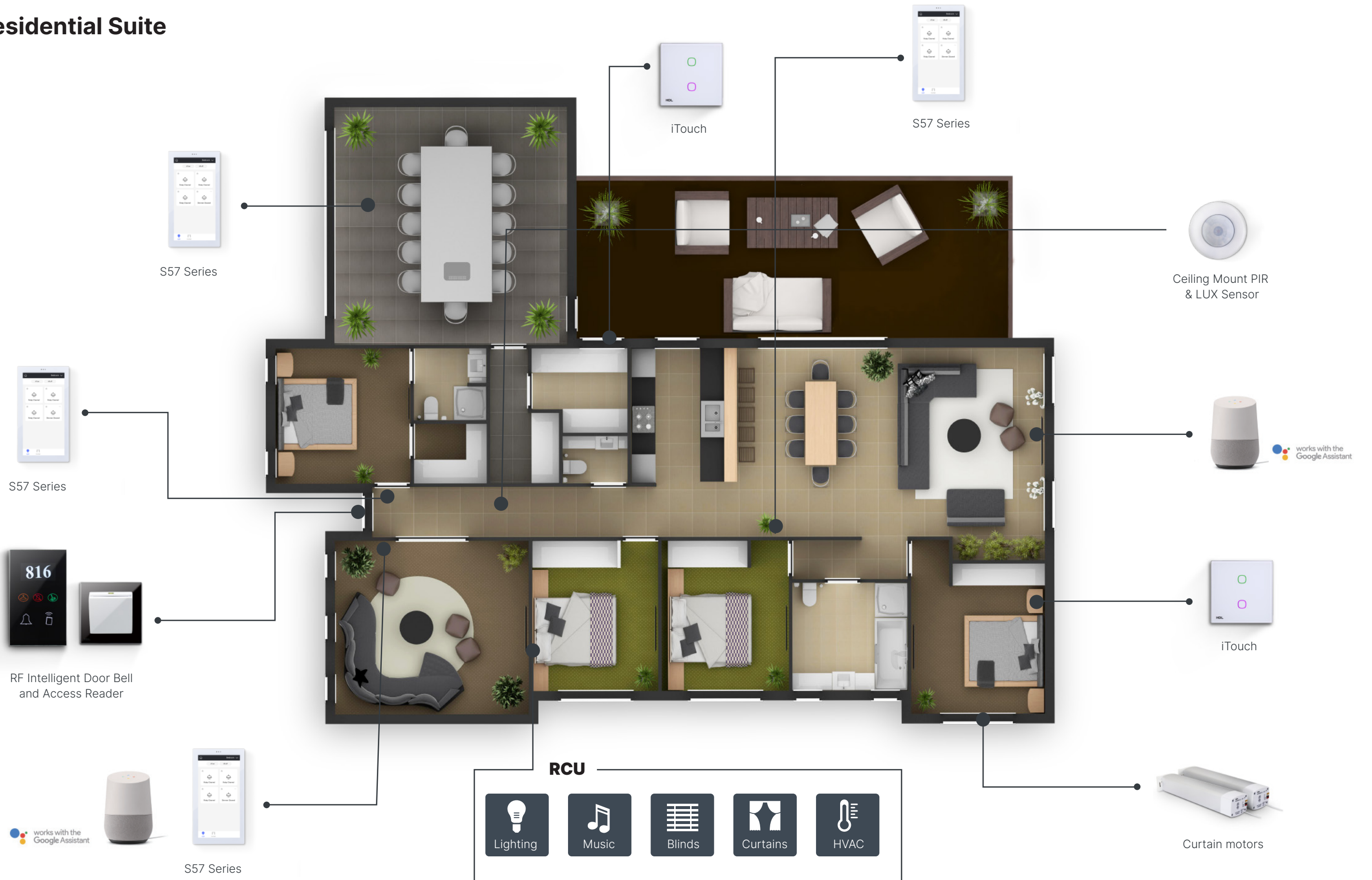

HO

SOLUTIONS FOR PUBLIC AREAS

- Lobby •
- Façade lighting •
- Café / Restaurant •
- Banquet hall •
- Spa •
- Gym •
- Recreation center / Shopping corridor •
- Conference room •
- Corridor & Stairwell •
- Garage •
- Landscape lighting •



Lobby

Guests always get the first impression of the hotel from its lobby.

Because of this creating a welcoming atmosphere is crucial.

Through carefully controlled lighting and HVAC, HDL is able to ensure that your hotel always makes a lasting first impression.



Lighting



Scene control



Background music



Lux sensor



Air conditioning

Façade lighting

A hotel with wonderful exterior lighting may surprises guests in the first impression. HDL system can automatically turn the façade lighting on according to the weather, season changes, etc. It also graces the city by brightening the buildings at night.



Preset lighting effect

Café / Restaurant

To create a pleasant dining environment for customers, ambient lighting and music can be set to fit the different scenes at any time according to customer`s requirements, seasons or occasions. For example, Romantic Mode with lower brightness and more colors set for Valentine`s Day.



Background music



Stage lighting



Air conditioning

Banquet hall



Not only the HDL system creates an elegant lighting effect in the banquet hall, but it also integrates with other stage equipment to meet different needs like wedding banquet. The HDL system allows hotel staff to control the chandeliers, strip lights, downlights, wall lamps as well as stage lights. Special visual effects can be achieved during the ceremony or when everybody is enjoying the delicacies of the banquet.



Chandeliers



Strip lights



Downlights



Wall lamps



Stage lights



Music



Air conditioning

Spa

A spa would totally be a plus in a hotel, where a place gives guests relaxation physically and mentally. HDL can specially develop a SPA control system for the hotel.

It mainly controls the ON/OFF of water, fountain and drain valve. At the same time, by installing an LED display beside the pool, it is convenient for guests to check the water temperature in real-time.



 Lighting

 Drain valve ON/OFF

 Fountain ON/OFF

 LED display



Gym



The lighting, temperature and music matter a lot in a gym. HDL hotel management system can automatically adjust the temperature according to the sensors' detection as well as centrally control the lights and music. For example, keep the dynamic music on and dim the lights for some sports like spinning, while play some lively music and set the bright mode for the yoga area.



Lighting



Temperature



Music

Recreation center / Shopping corridor



Recreation center



Lighting



Stage lighting



Video surveillance



Emergency lighting



Background music



HVAC

Apart from controlling conventional lighting equipment, the system can connect integrate stage lighting devices via DMX512, which is capable of creating eye-shocking lighting effects. The guests can relax and get an enjoyable experience in the recreational center/shopping corridor.



Shopping corridor

Conference room



SCENE:

Different intelligent modes can be created by programming the blinds, projector, screen, lights, air-conditioner and other devices in the meeting room to be used on various occasions. One-touch on the panel can run multiple devices. For instance, when the user selects the Meeting Mode, the system will turn on all lights, close the blinds and activate the air-conditioner.



Meeting Mode



Projector Mode



Leaving Mode



Cleaning Mode



All On



All Off



Panel



Lighting



Air-conditioning





Blinds

Corridor & Stairwell

Corridor and stairwells are essential to any hotel, and although only briefly occupied, can contribute significantly to a building's overall energy expenditure. With HDL's extensive range of on-demand lighting solutions, lighting fixtures can be turned off or dimmed when a hallway is unoccupied, and return to their normal operational state when approached by a guest or a member of staff.



Building Management System

Brightness control

Video surveillance

Emergency lighting

Motion sensor

Logic setting

Garage



The lights for lanes are on while lights over parking spaces are off by default. If a car enters the parking garage, the system will turn on the lights over empty parking spaces to help the guest find the parking space with less time. Meanwhile, lighting management of the parking garage is improved, for the clerk in the garage are enabled to control all the lights on wall panels or mobile phones.



Lighting



Timing event



Logic setting



Video surveillance



Motion sensor



Centralized control

Landscape lighting

When the night draws in, the system will automatically turn on the landscape lighting equipment. Different lighting effects can be applied to the hotel's garden, making it a beautiful place and stand out in the night.



Timing irrigation



Flood lighting



Timing event



Lux sensor



Swimming pool



Logic setting



Video surveillance



The technology behind the solutions

HDL offers comprehensive smart hotel solutions based on innovative systems, which are reliable and efficient while bringing down the cost of use and maintenance for hotels.

Meanwhile, HDL hotel solutions are compatible with a variety of mainstream protocols and interfaces such as RS485, RS232, DMX512, OPC, ART-NET, BACNET, MODBUS, DALI, to integrate different products.

TCP/IP Topology

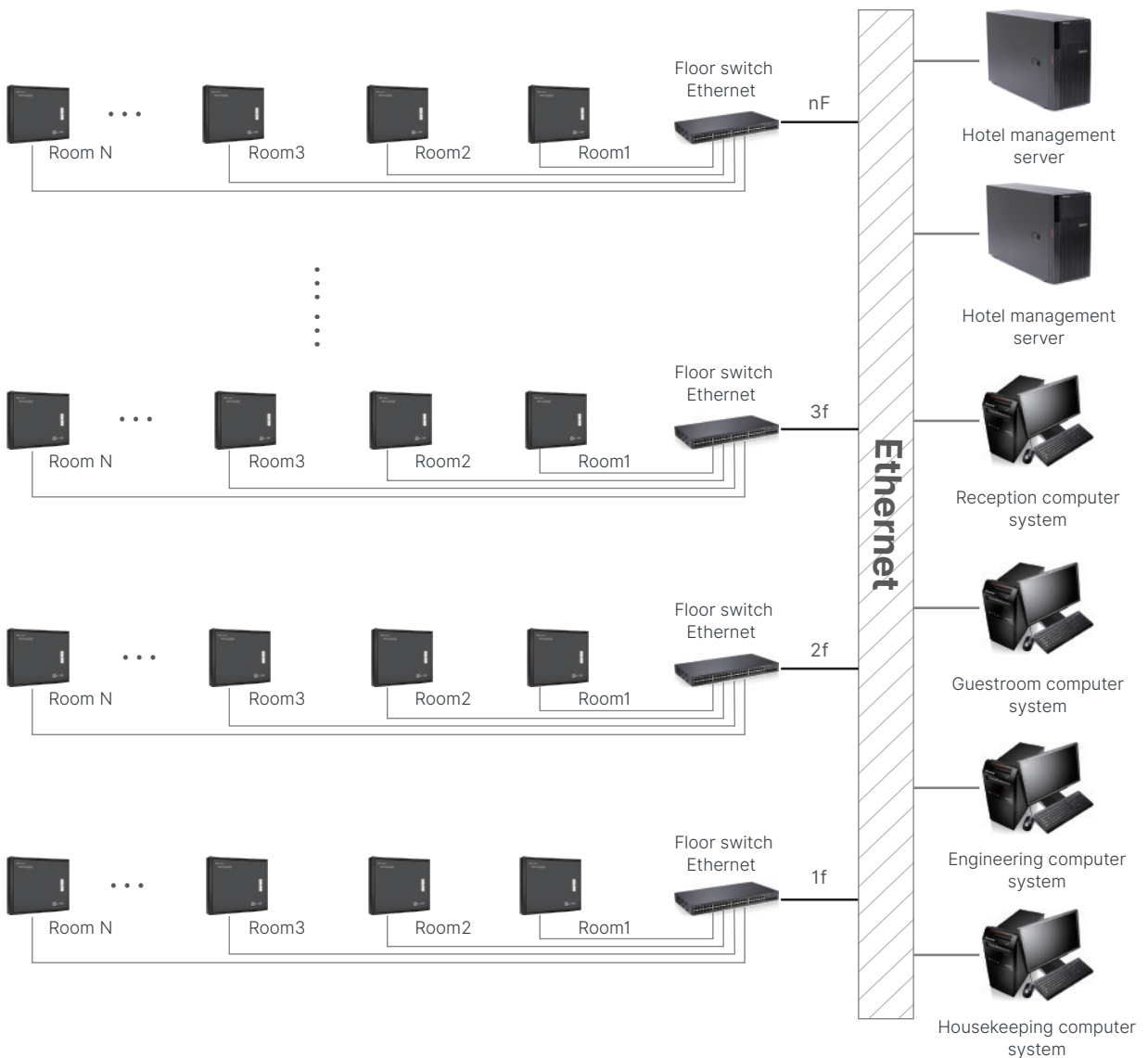

Modular Intelligent Hotel Guestroom Control System

Premium Version

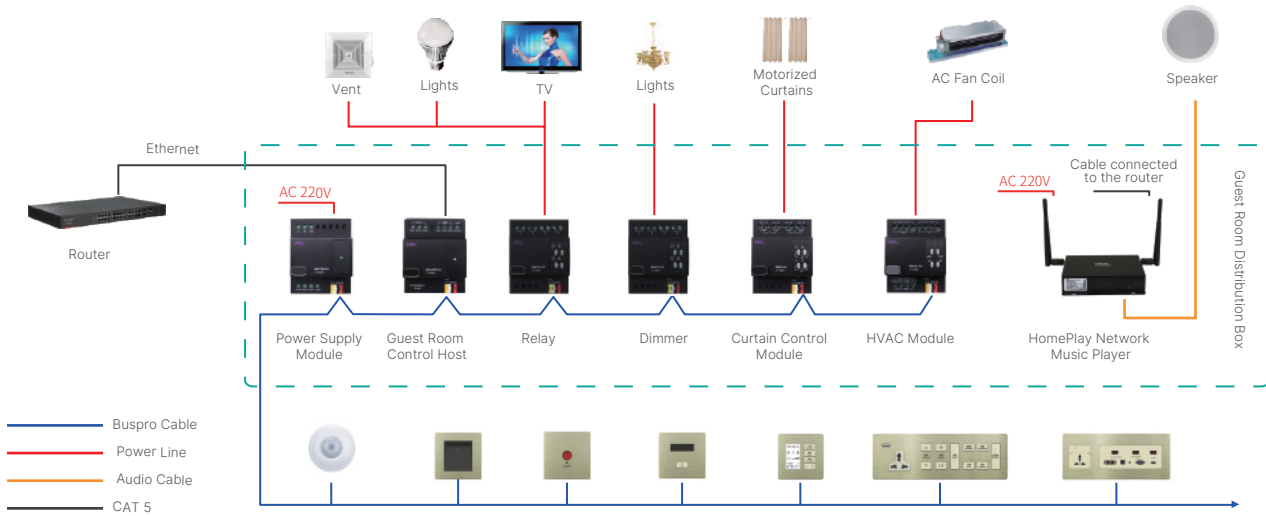

Basic Version

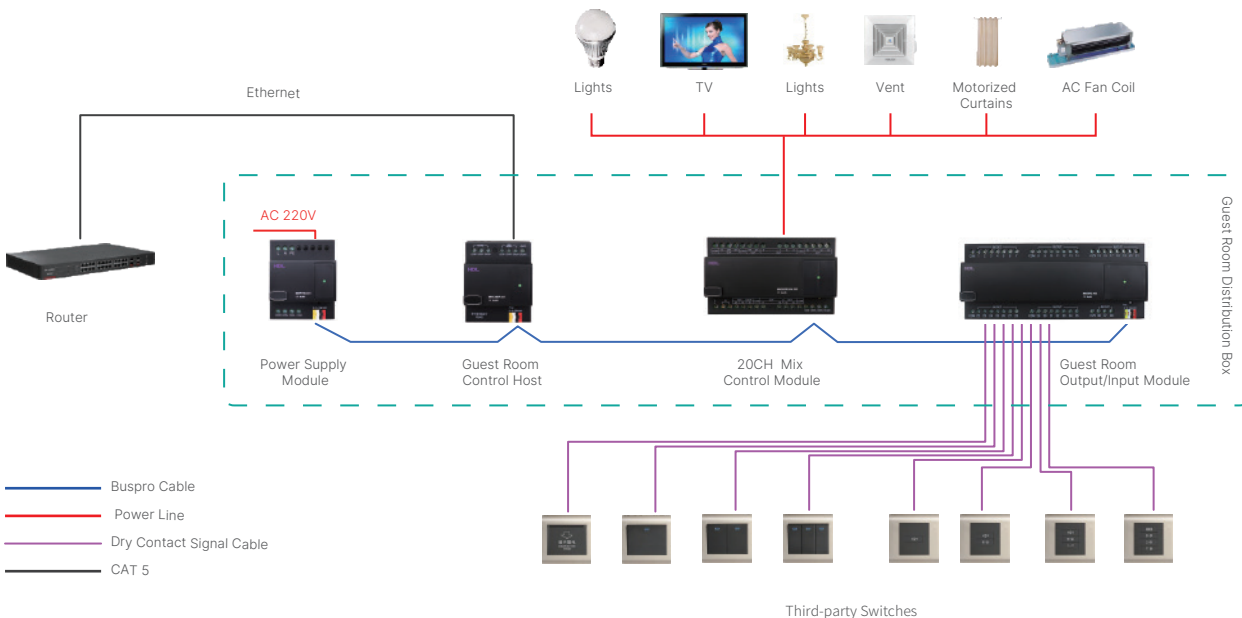

RCU Intelligent Hotel Guestroom Control System

Premium Version

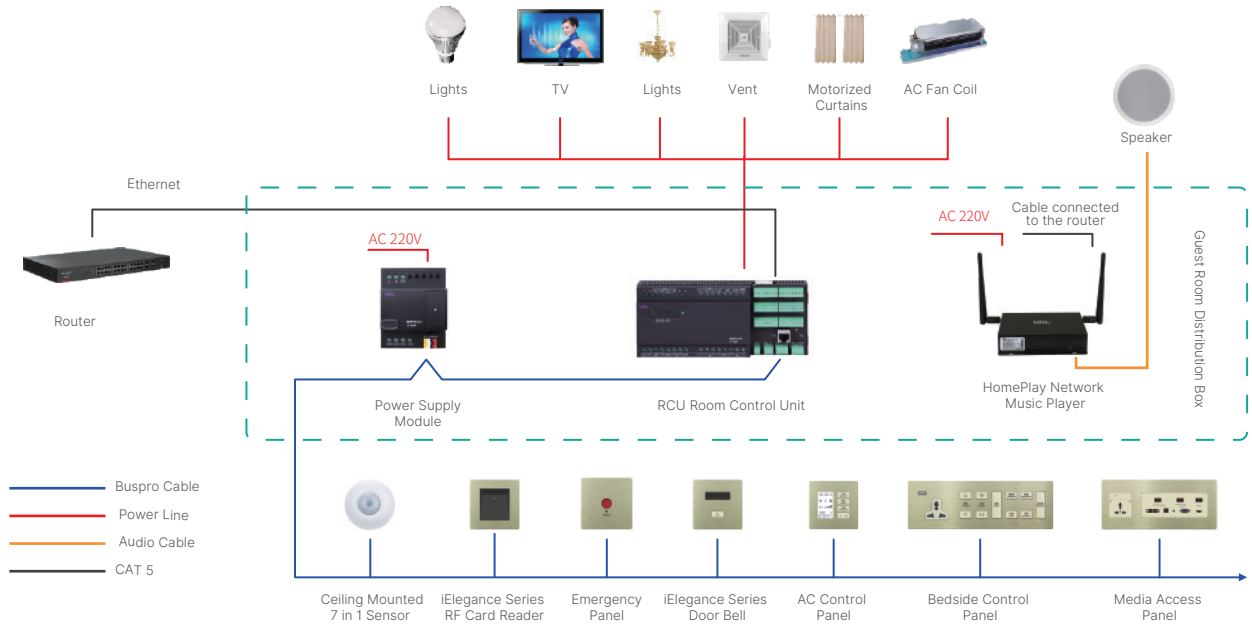

Basic Version

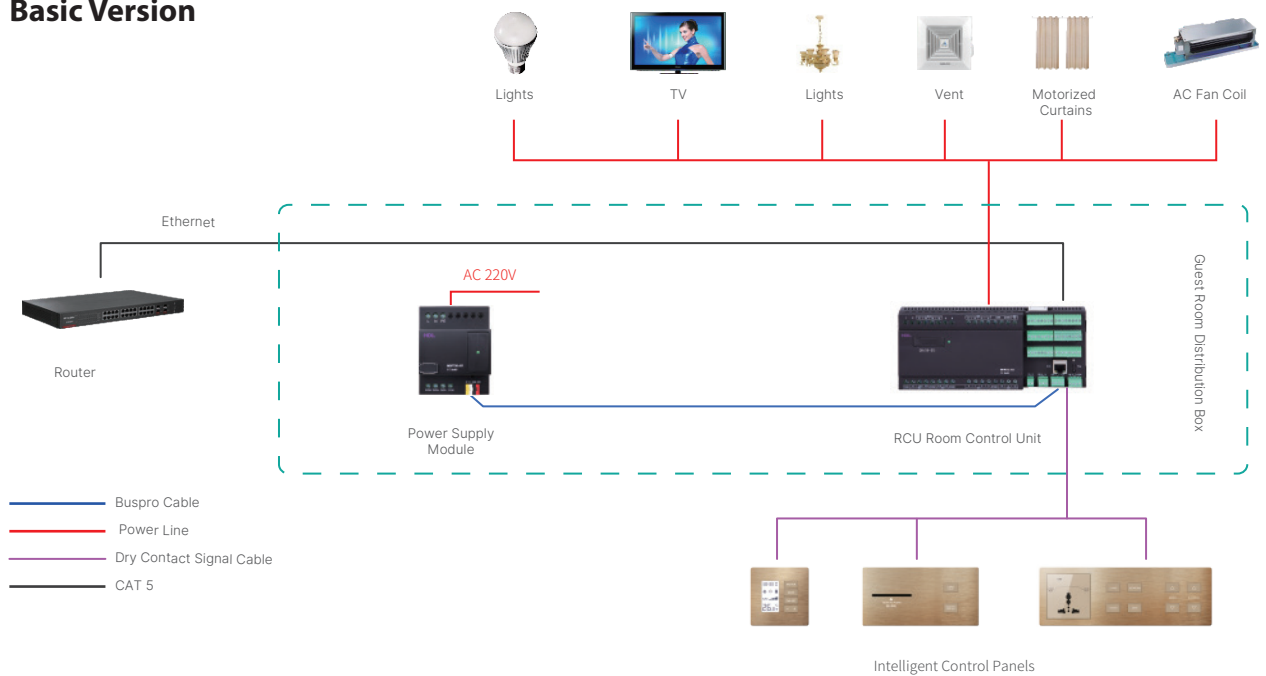

Granite Display



MPTL4C.48

Meant to be eye-catching.

Granite Display is designed to be a gorgeous ornament making your place look better. Just a glance, you would be stunned by its extraordinary beauty.

Granite Display
New Generation User Interface.

Give it a touch, you would love to use it.

We redefine wall panel user experience by adding to the Granite Display our new generation user interface. With the responsive high-resolution display, you will fall in love with it the moment you touch the panel.

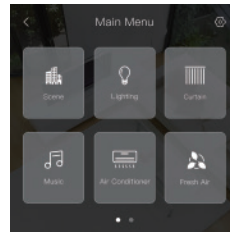

Main Menu



Air Conditioning

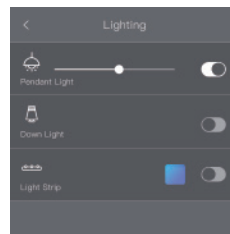

Lighting

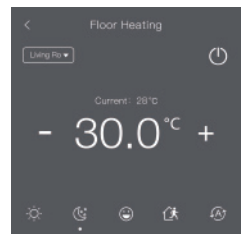

Floor Heating

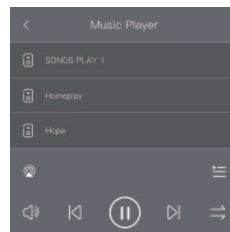

Music Player

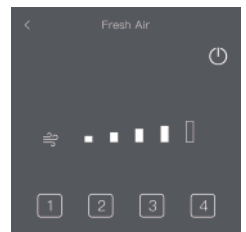

Fresh Air

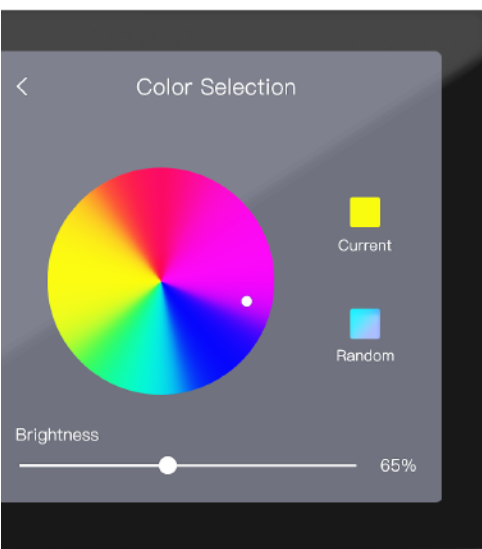

- Beautiful and user-friendly interface
- 720 x 720 HD 4.0-inch display
- Blasted finish aluminum frame
- Built-in proximity sensor, temperature sensor, humidity sensor
- **Power supply:** 24V DC
- **Dimensions:** 86 x 86 mm (EU)

S10

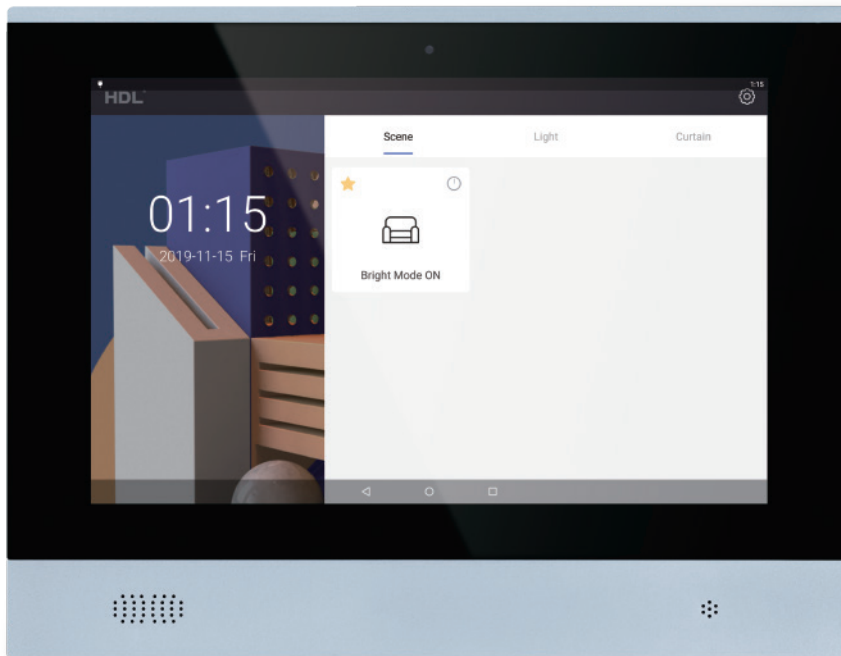

MTS10B.2WI

Add credits to interior decoration in a perceptible way.

S10 is a touch panel equipped with a 10.1-inch 800 x 1280P HD display and a dedicated user interface. With the excellent industrial design and UI, a panel of such size will just make your building more beautiful apart from its tech features.



- 10.1-inch 800X1280P display
- 2 MP front facing camera
- Built-in echo-cancellation circuit
- High-sensitivity microphone and low-distortion speaker
- Built-in real-time clock (RTC)
- Built-in proximity sensor, temperature sensor
- **Power supply:** DC 9 ~ 25V
- **Communication:** IP, RS485 (Not Buspro)

S57

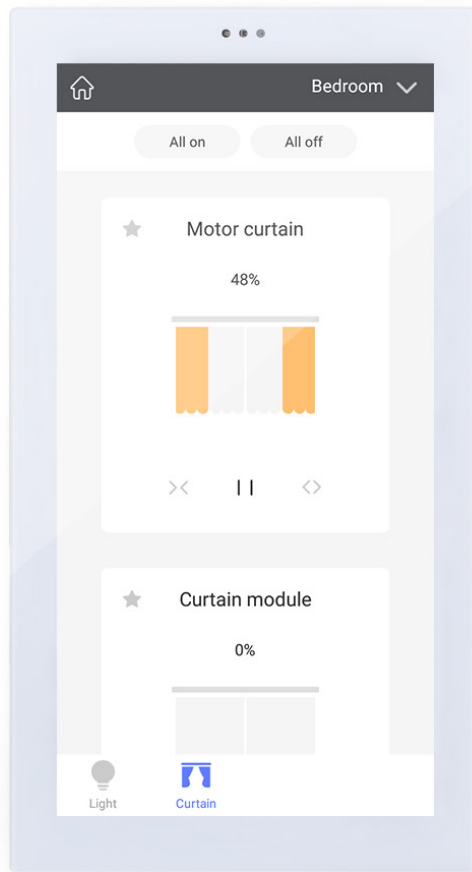

MTS57.1WI

Quick and full control experience.

With an 18:9 aspect ratio display embedded in the crystal white panel, S57 stands out among its rivals. The slim body makes it different. You can have quick and full control experience on S57.

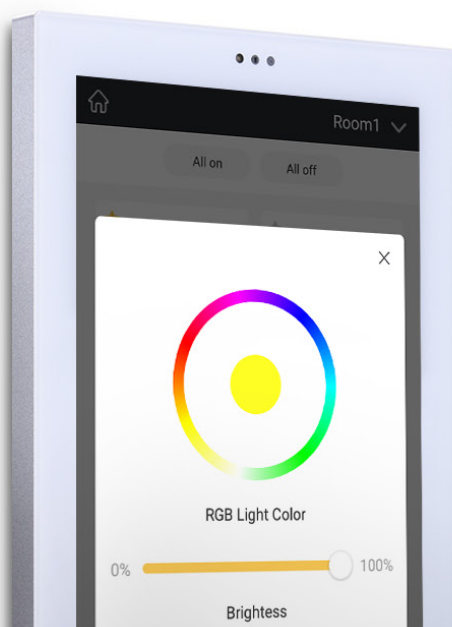
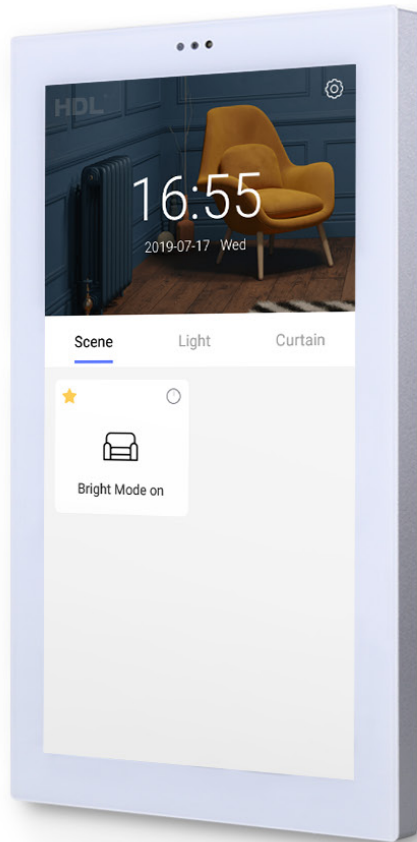

- 5.7-inch 1280 x 640P display with 18:9 aspect ratio
- Built-in proximity sensor, brightness sensor
- Built-in microphone and speaker
- **Power supply:** DC 24V or PoE
- **Communication:** Bluetooth, Wi-Fi, IP

Tile

Premium quality with two materials.

Tile series comes with two versions of different materials: metal and plastic. Each one is able to give you a sense of premium quality, either with the refined sandblasting finishes on the metal one or the skin-like touch feeling on the plastic one.

Color:

Plastic: Ivory White Ash Gray

Metal: Champagne Gold Space Gray



MPL6B/TILE.48



MP1B/TILE.48

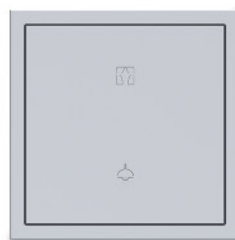

MP2S/TILE.48



MP2B/TILE.48



MP4S/TILE.48



MP4B/TILE.48

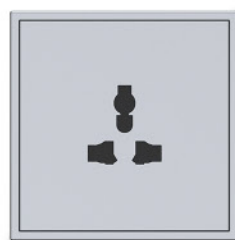

MP1-S-M-EU/TILE.48



MP1-E/TILE.48

Control everything you need with buttons.

The basic unit of Tile is a keypad or socket panel in EU standard. You can use just one unit if it meets your requirement, or combine multiple units to serve more functionality in a specific area.

- Supports various types of control targets
- Flexible combinations for required functionality
- RGB icon backlight
- Customizable button icons
- Users are allowed to set the colors of icon backlight
- Available in two materials and four colors



MP1-W-TEL/TILE.48

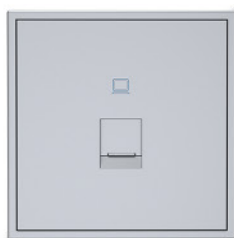

MP1-W-ETH/TILE.48



MP1-S-EU/TILE.48



MP1-W-CATV/TILE.48.48

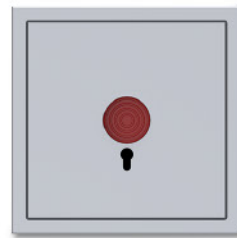

MP1-E/TILE.48



MP2-W-USB/TILE.48

- Horizontal

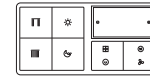

2-Gang

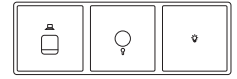

3-Gang

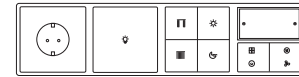

4-Gang

- Vertical



2-Gang



3-Gang

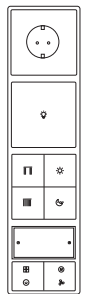

4-Gang

DLP



MPL8.48-A



MPL8.46-A

A multi-functional push button keypad.

If you prefer physical buttons but want to have a display to indicate the control targets, then the DLP panel is here for you.

- Mono-color LCD
- Supports 147 languages
- Customizable icons or captions
- Built-in temperature sensor
- Aluminum frame
- **Power supply:** DC 24V

Dimensions: 86 x 86 mm (EU), 86 x 116.5 mm (US)

Enviro

What you see is what you control.

Enviro is a touch-control panel equipped with a 4.3-inch display. It allows you to control lighting, curtains, HVAC, music and more functionalities effortlessly on its graphic user interface. What you need to do is just a touch on the screen.

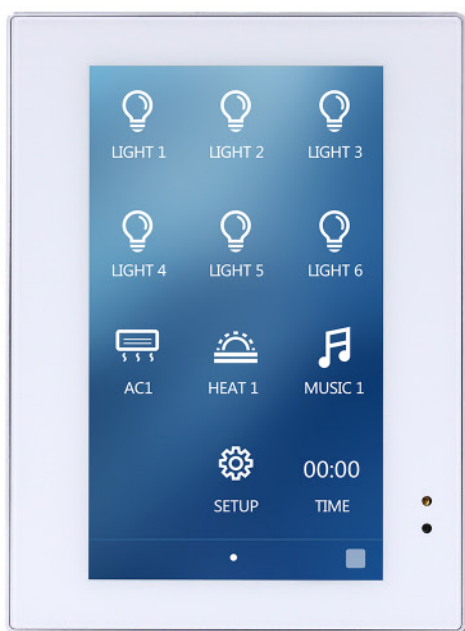

MPTLC43.46-A

- Color capacitive touch display
- Customizable UI
- Built-in proximity sensor
- Built-in temperature sensor
- Built-in IR receiver
- Built-in real-time clock
- Aluminum frame
- **Power supply:** DC 24V
- Colors: White, black
- **Dimensions:** 86 x 116.5 mm (US)

iTouch



MPT2.48-A



MPT4.48-A

A graceful touch to control.

iTouch is always a great option if you are looking for a beautiful keypad of minimal design. Its body is enclosed by a fine aluminum frame, while the face is a piece of glass with touch buttons. It perfectly matches any interior decoration.

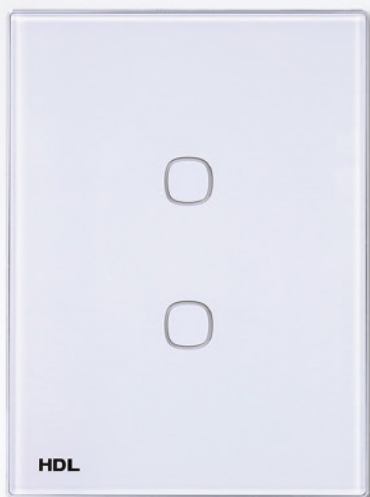

MPT2.46-A

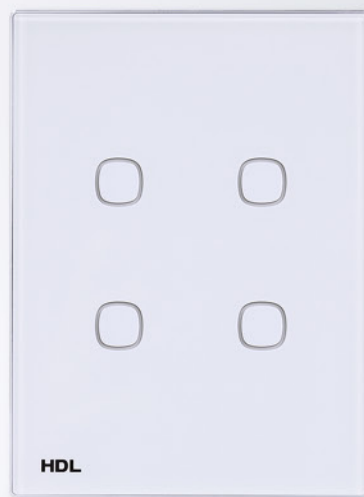

MPT4.46-A

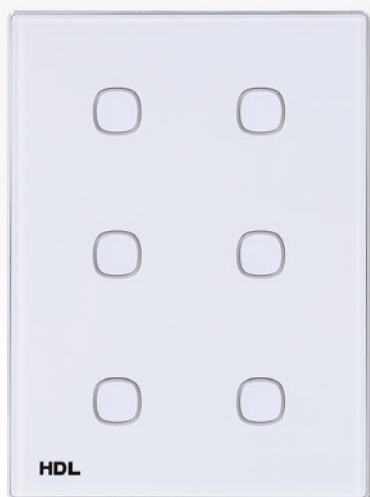

MPT6.46-A

- Touch button with RGB backlight
- Aluminum frame
- Supports online upgrade
- **Power supply:** DC 24V
- **Dimensions:** 86 x 86 mm (EU), 86 x 116.5 mm (US)

iElegance

Metal is always attractive.

Metal has been a favorable material since the early age of human history. It's some how a signature of reliability. So, we make the iElegance panel with brushed metal finish. It's sturdy and never dies in fashion. You can either match it with vintage style interior decoration or modern one.

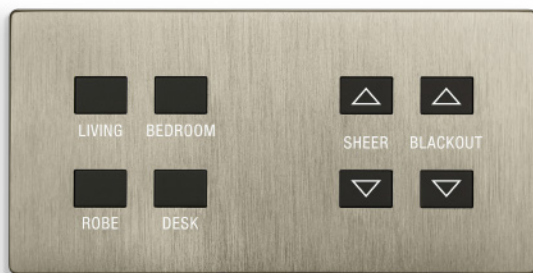

- Brushed metal finish
- Power supply: DC 24V

MPH108.48



MPH101.48

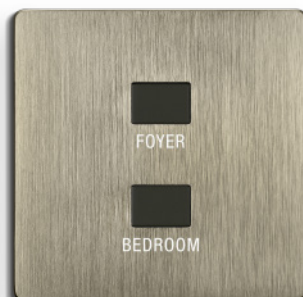

MPH102.48



MPH104.48

- PRIVACYstatusdisplay
- Visitingfunction
- Support HDL Buspro online upgrading
- Power supply: DC12-30V
- BUS power consumption: 24mA / DC24V
- Dimensions: 86×86x22.2(mm)
- Weight: 98g

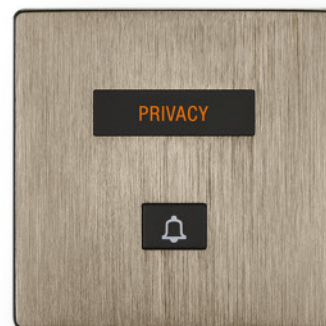

MPB01.48

- Visiting function, time setup
- Do not disturb
- Please clean
- Backlight brightness adjustable
- Support HDL Buspro upgrading
- Power supply: DC12-30V
- BUS power consumption: 25mA / DC24V
- Dimensions: 86×86x22.2(mm)
- Weight: 98g



MPB03.48

- Control temperature, speed, mode, on/off
- Air conditioning mode: cooling, heating
- Speed: high, low, medium
- Displayindoortemperatureandairconditionstatusetc
- Support HDL Buspro online upgrading
- Power supply: DC12-30V
- BUS power consumption: 25mA / DC24V
- Dimensions: 86×86x22.2(mm)
- Weight: 97g



MPAC01.48

Notification Stations

A guest's privacy is priceless.

First impressions form lasting memories. That's why the HDL smart guest room experience starts before a guest even enters their room. Choose from two customizable notification stations which show the room number as well as laundry, cleaning, and do not disturb indication.

To make access to the room even easier, the notification stations also features RFID card technology. This means a guest need only swipe their room card to open their door.



MHBREF.1010



MHBREF.1010

- Shows room numbers, indicates the information of Laundry, DND and Clean Room
 - 2 dry contacts
 - Door bell
 - Open the Door by RF card & history record function
 - Power supply: 12~30V DC
 - Communication: HDL Buspro
 - Dimensions: 105×170×35 (mm)
- Shows room numbers, indicates the information of Laundry, DND and Clean Room
 - Door bell
 - Power supply: 12~30V DC
 - Communication: HDL Buspro
 - Dimensions: 105×170×35 (mm)



- Power supply: 12~30V DC
- Communication: HDL Buspro
- Dimensions: 86×86×10.5 (mm)

MPTB01RF.48

- Optional backlight RGB colors
- Door bell for visitors
- Display requirement of cleaning room
- 1-99 targets can be controlled when user touch the door bell
- 1-49 targets can be controlled when user swipe the card
- The touch sensitivity can be adjusted

Ecomaster Card Switch



MHIC.48



Your guest room made energy efficient.

Created to activate or deactivate a room's electrical system, the Ecomaster card range enables hoteliers to dramatically increase their energy efficiency. With the ability to activate different scenes when different cards are inserted, the Ecomaster card switches can personalize how a guest experiences their room.

From automatically activating the lighting, to triggering a welcome message, the card switches deliver a truly efficient customizable environment.



MPTC03.48



MPTC03.46

- Master card for energy & power management
- 3 touch buttons, sensitivity can be adjusted
- Button color RGB can be adjusted
- The touch button can be used as the panel button, or work with HDL touch door bell panel, can be displayed DND, Clean, Wait
- Control of mechanical switch can be configured when inserting or taking off the card.
- Up to 49 targets can be controlled by the switch. Maximum 99 targets can be controlled by other button modes

Power supply	12~30V DC
Supported card type	MIFARE ONE S50 13.56MHz
Communication	HDL Buspro
Dimensions	86×86×20.4 (mm) (EU) 86×86×20.4 (mm) (EU) 116×86×20.4 (mm) (US)

7 in 1 Sensor



- Built-in PIR sensor, temperature sensor, light sensor
- Two dry contacts
- Two universal switches
- Power supply: DC 24V
- Buspro power consumption: 5mA / DC 24V
- Detection diameter: Φ 8m (Installation height:3m)
- Temperature detection range: $-20^{\circ}\text{C}\sim 60^{\circ}\text{C}$
- Illumination detection range: 0~500Lux
- Dimensions: Φ 84mm \times 37.5mm
- Net weight: 55.4g

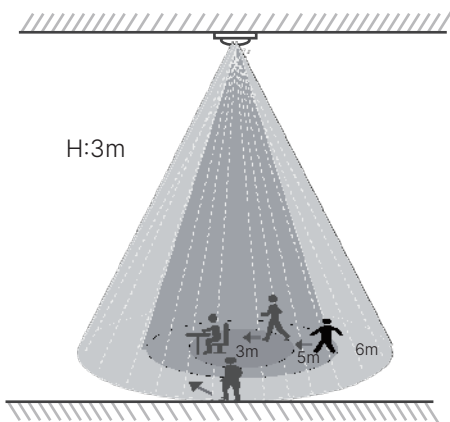

Detection Range(At 25°C)

Mounting height	Sitting / Walking towards constantly	Walking towards with pause
3m	3m	5m

- Walking across
- Walking towards with pause
- Sitting / Walking towards constantly

12 in 1 Sensor



MS12.2C

- Built-in PIR sensor, light sensor, ultrasonic sensor, temperature sensor
- Built-in IR receiver, IR emitter
- Two dry contacts
- Two universal switches
- Two relay channels
- Power supply: DC 24V
- Static power consumption: 40mA / DC 24V
- Dynamic power consumption: 90mA / DC 24V
- IR transmit frequency: 38KHz
- IR emission distance: 4m
- Illumination detection range: 0-5000Lux
- PIR sensing range in diameter: 6m (install height-3m)
- Ultrasonic sensor in diameter: 8m
- Dimensions: $\Phi 110\text{mm} \times 35\text{mm}$
- Net weight: 207g

Ultrasonic Detection Range

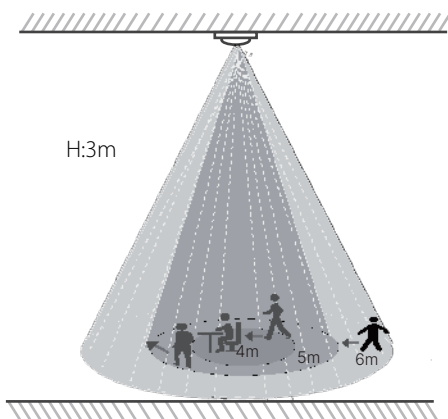

- Walking towards with pause
- Walking across
- Sitting / Walking towards constantly

PIR Detection Range

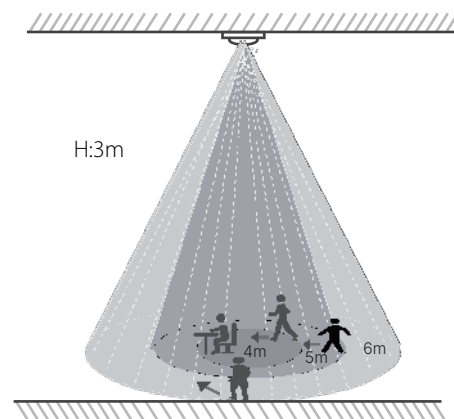

- Walking across
- Walking towards with pause
- Sitting / Walking towards constantly

Ultrasonic Detection Range(At 25°C)

Mounting height	Sitting / Walking towards constantly	Walking across	Walking towards with pause
3m	4m	5m	6m

PIR Detection Range(At 25°C)

Mounting height	Sitting / Walking towards constantly	Walking towards with pause	Walking across
3m	4m	5m	6m

Shading Control

Curtain Motor

With the HDL curtain motors, your curtains can run the full way to close and open while can be stopped at any position a Stop button. Or you can select a percentage to let them stop at a preset position.



MWM65B.20

- Control Mode: close, open, stop, percentage
Pull to activate motor
- Supports manual control when power off
- Quiet running
- Buspro power supply: DC 24V
- Rated voltage: 12-30V DC
- Motor rotate speed: 95rpm
- Rated torque: 1.2Nm
- Terminal wire diameter: 0.6-0.8mm
- Dimensions: 283×71×50.6(mm)
- Net weight: 996g

Shading Control

Tubular Blind Motor



- High-accuracy position limit
- Internal structure is sealed and lubricated for low noise and vibration
- Overheat and overload protection
- Flame-retardant material for low fire risk
- Supports open, stop, close and percentage control
- Supports remote control
- Ultra-quiet at 35dB
- The motor and aluminum tube are assembled together by default



MVSM35B.12

- Working voltage: 12-30V DC
- Working current: 6mA / 24V DC
- Rated input voltage: AC 220-240V (50Hz)
- Rated input current: 0.9A
- Motor torque: 3N.m
- Motor rotate speed: 22rpm
- Dimension: $\Phi 35 \times 528$ (mm)
- Weight: 1224g (Motor)

RCU



MHRCU.433

- Built-in gateway with IP interface
- CH 1 to 13: 5A relay output
- CH 14 to 17: 10A replay output
- CH 18 to 21: 1A dimmer output
- Power supply: DC 24V
- Static power consumption: 300mA/24V DC
- Relay output: 5A/10A
- Dimension: 216×90×56(mm)
- 35mm DIN Rail installation
- Net weight: 725g

Room Control Host



MHC48IP.431

- Works with other HDL hotel modules as a gateway
- Manages up to 48 channels
- Power supply: DC 24V
- Buspro power consumption: 30mA/24V DC
- Dimensions: 72×90×64 (mm)
- 35mm DIN Rail installation
- Net weight: 143g



MHC48IP/D.431

- Works with other HDL hotel modules as a gateway
- Manages up to 48 channels
- Power supply: DC 24V
- Buspro power consumption: 600mA/DC24V
- Dimensions: 72×90×67.5 (mm)
- 35mm DIN Rail installation
- Net weight: 130g

22CH Mix Controller / 51 Dry Contact Module

- 20 channels of relay output
- 2 channels of MOSFET dimmer output
- Easy configuration



MHMIX22.232

- Power supply: DC 24V
- Static power consumption: 15~30V DC
- Dynamic power consumption: 180mA/24V DC
- MOS tube voltage input: AC100~240V(50/60Hz)
- Dimensions: 144mm×90mm×64mm
- Net weight: 572g



MHS51.231

- Power supply: 24V DC
- Working current: 280mA/24V DC
- Output current: Max. 8mA/CH
- 35mm DIN rail installation
- Dimensions: 72mm×90mm×67.5mm
- Net weight: 387g

I/O Module

- 12 channel outputs for dimming, relay, and curtain control 19 channel inputs for dry contact and doorbell control
- Compatible with multiple load types such as incandescent lighting, halogen lighting, LED lighting, etc.



MHIU-II.432

- Power supply: DC 24V
- Static power consumption: 30mA/DC24V
- Dynamic power consumption: 185mA/24V DC
- Dimensions: 144×90×56 (mm)
- 35mm DIN Rail installation
- Net weight: 375g

4CH 0.5A Universal Dimmer / 5CH High Power Relay



MHD04A.231

- Power supply: DC 24V
- Working voltage: 15~30V DC
- Input voltage: AC100~240V(50/60Hz)
- Dimensions: 72×90×64 (mm)
- 35mm DIN Rail installation
- Net weight: 234g

Output channel

Enables the switch control between four channels of 0-10V dimming output and four channels of MOSFET dimming output.



MHR05L.231

- Power supply: DC 24V
- Working voltage: 15~30V DC
- Emergency channel:
2CH/5A (AC220V 50Hz) Emergency relay (CH1~2)
- Dimensions: 72×90×64 (mm)
- 35mm DIN Rail installation
- Net weight: 418g

Output channel

2CH/10A (AC100~240V 50/60Hz) Relay (CH3, CH5)
1CH/5A (AC100~240V 50/60Hz) Relay (CH4)

10CH / 20CH Mix Controller



MHD02R18U.232

- Power supply: DC 24V
- Input voltage: AC100-240V(50/60Hz)
- Relay output: 5A/10A resistive loads
- Dimming output:
1A silicon-controlledrectifier outputs
- 35mm DIN rail installation
- Dimensions: 144×90×64(mm)
- Net weight: 564g



MHMIX10.231

- Power supply: DC 24V
- Input voltage: AC100-240V (50/60Hz)
- Dimming mode: MOSFET trailing edge
- 35mm DIN rail installation
- Dimensions: 72mm×90mm×64mm
- Net weight: 418g

	6CH/5A(AC100-240V 50/60Hz) Relay (CH1~4, CH6~7)
Output channel	2CH/10A(AC100-240V 50/60Hz) Relay (CH5, CH8)
	2CH/0.5A (AC100-240V 50/60Hz) MOSFET dimming (CH9~10)

RS232/RS485 Gateway



MRS232U.431

- Power supply: DC 24V
- Buspro power consumption: 15mA/DC24V
- Communication: HDL Buspro/RS232/RS485
- Dimensions: 72×90×66 (mm)
- Weight: 310g

Shading Control

2CH Curtain Controller



MW02.431

- Working voltage: 15~30V DC Class 2
- Bus power consumption: 35mA/24V DC
- Maximum current per CH: 5A
- Relay life time: >60000 (Resistance load)

750mA/1200mA Power Supply Module



MSP750.431

- Input voltage: AC100-240V(50/60Hz)
- Output current: 750mA
- Output voltage: 24V DC
- Output ripple wave: Less than 150mV
- Dimensions: 72×90×64 (mm)
- 35mm DIN Rail installation
- Net weight: 188g



MSP1200.431

- Input voltage: AC100-240V(50/60Hz)
- Output current: 1200mA
- Output voltage: 24V DC
- Output ripple wave: Less than 150mV
- Dimensions: 72×90×64 (mm)
- 35mm DIN Rail installation
- Net weight: 188g

HomePlay



MZBOX-A50B.30

- **Power Amplifier Rated output:**
32W+32W (8Ω/ohms, 1kHz, 0.7%)
- **Speaker Impedance:** 4-32Ω
- **Dynamic Range:** >87dB
- **S/N Ratio:** >88 dB
- **Stereo Separation:** >81.5dB (1KHz)
- **Frequency Response:** 20Hz to 20KHz (±3dB)
- **Power supply:** AC100-240V, 60/50Hz/DC
- **Input:** DC24V @ 3.3A
- **Dimensions:** (H x W x D)144mm
(184mm with antenna) x112mmx31mm
- **Weight:** 1.3Kg

Multi-platform Compatibility

At HDL we know that everyone has their preferred method of audio storage. That's why we've given HomePlay true multi-platform compatibility.

With Bluetooth and WiFi connectivity, a LAN port, and a USB port HomePlay can directly connect to your audio library. Seamlessly controlled through the HDL On app, you can stream all of your favorite tracks to any room to create your ideal audioscape.



Better Together

Quickly and intuitively browse through the entirety of your music collection.

With the ability to directly play files from network attached storage devices (NAS), an onboard Micro SD card slot, an onboard USB port, and your connected iOS & Android devices, total audio management has never been easier.

This coupled with native MP3, WMA, AAC, AAC+. ALAC, FLAC, APE, and WAV format support makes all your music just a tap or click away.





9 Advantages Of Our System



CASE STUDIES

- *Morpheus Hotel, Macau*
- *Gevora Hotel, Dubai*
- *InterContinental London*
- *Park Hyatt Sydney, Australia*
- *The Apurva Kempinski Resort, Indonesia*
- *Dobrograd Park Hotel, Russia*
- *DoubleTree by Hilton Antalya City Centre, Turkey*





Morpheus Hotel, Macau

Designed by the legendary architect Zaha Hadid, Morpheus is the new flagship hotel for the City of Dreams Macau. Its public areas and 779 guest rooms are automated with HDL hospitality solutions. Intelligent control of lighting, HVAC and shading are made possible.

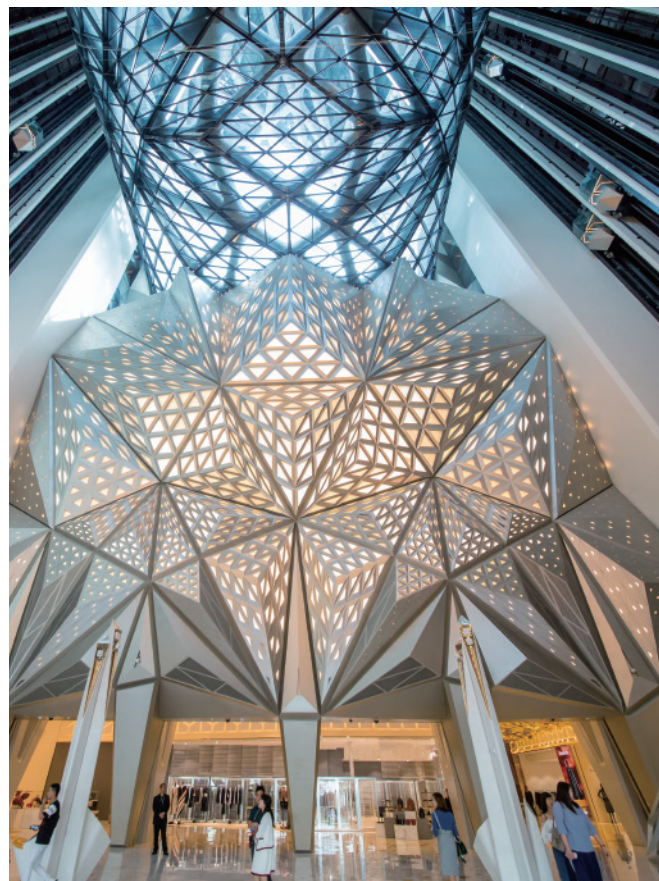

 Lighting

 HVAC

 Shading

Gevora Hotel, Dubai



According to Guinness Records, the Gevora Hotel in Dubai, with a height of 356.33 meters, has been crowned the tallest hotel in the world. And this tallest hotel adopted the HDL Buspro Wireless system to achieve automation for the lighting control in the guestrooms.

 Lighting

 HVAC

 Shading

InterContinental London

Situated a stone's throw away from the O2 Arena in the Greenwich Peninsula, the Arora Intercontinental provides guests with prime central London luxury accommodation. Each of the hotel's 450 rooms was fully upgraded with HDL KNX lighting solutions and customized HDL switches & panels for effortless illumination control.



Park Hyatt Sydney, Australia



Located in the Rock near the Sydney Harbor, the Park Hyatt itself becomes the best viewing platform for seascape. With HDL intelligent system installed, all the guest rooms realized the control of lighting, air conditioners, curtains, and so on via smart panels.

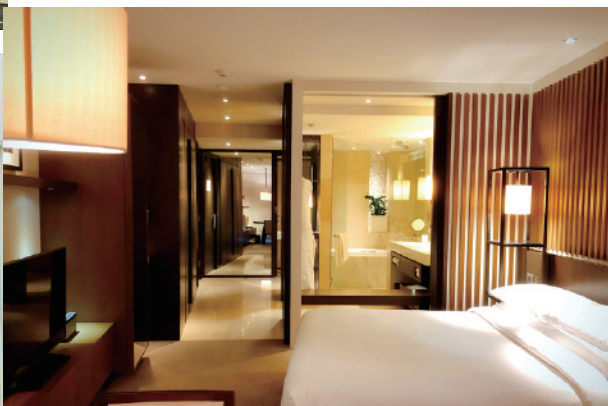

 Lighting

 HVAC

 Shading

 Music

 Monitoring system

The Apurva Kempinski Resort, Indonesia



Apurva means huge, enormous and extraordinary in Sanskrit. The Apurva Kempinski Resort has now become one of the instagramable resort in Bali. HDL Indonesia has finished the lighting control of 460 rooms and villas.



Lighting



Scene

Dobrograd Park Hotel, Russia



Dobrograd Park Hotel is not just a hotel, but a whole city including apartments for living, schools, hospitals, theater, parks, a hotel and even a small airport. HDL Russia has automated all the lighting, AC, heating and curtains in the hotel rooms. By integrating with the Hoteza system, guests are able to control everything through the App on iPad and TV.

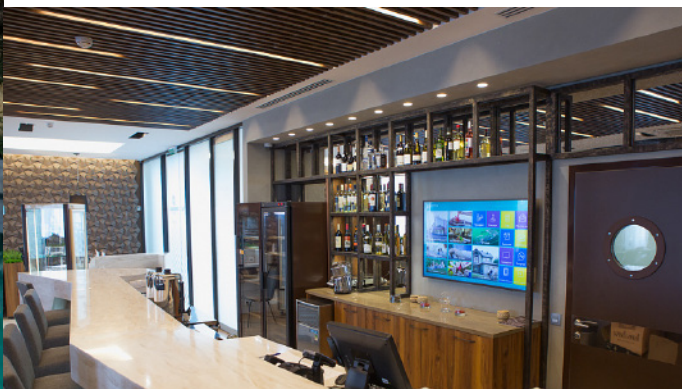

 Lighting

 HVAC

 Shading

 iPad

DoubleTree by Hilton Antalya City Centre, Turkey



Located at the center of the Antalya City, the most popular tourist city in Turkey, DoubleTree by Hilton has 150 rooms been automated. And all the rooms are installed MHIOU.432 modules with the integrated logic scene to control lighting systems in Welcome & Goodbye Scene.

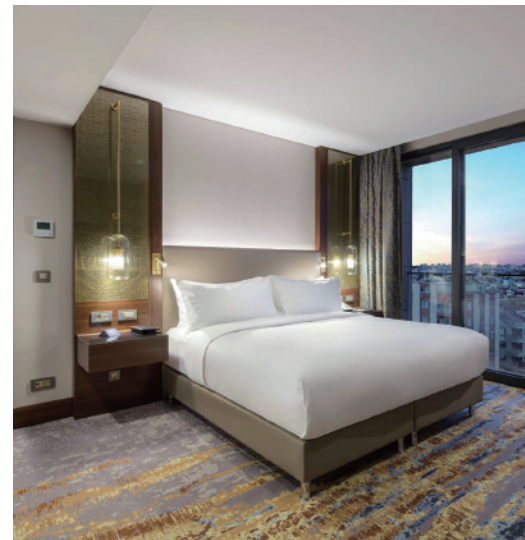
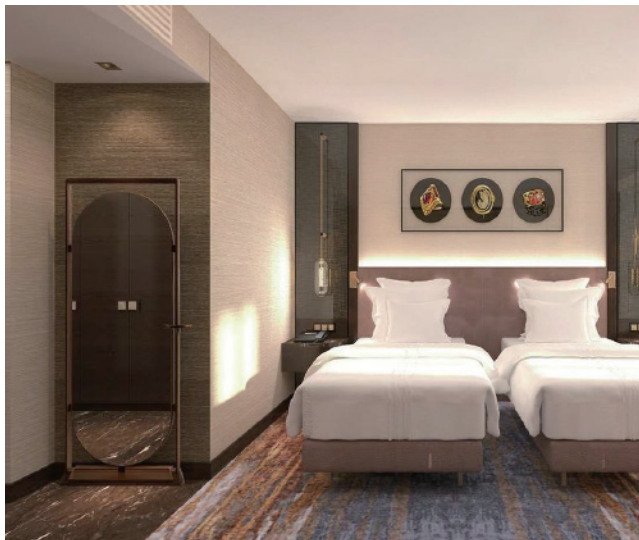

Lighting



Scene

HDL®

HDL[®]



HDL Automation

www.hdlautomation.com

sales@hdlautomation.com