

HDL-MPL8.48-A
 Modern Series DLP Smart Panel EU
 HDL-MPL8.46-A
 Modern Series DLP Smart Panel US

buspro

Datasheet

Issued: June 26, 2019
 Edition: V1.0.0



Figure 1. Modern Series DLP Smart Panel EU

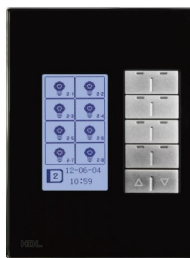
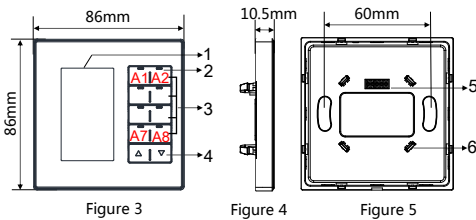
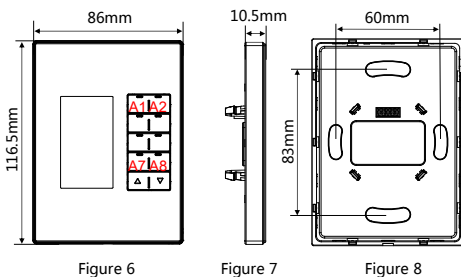

Figure 2. Modern Series DLP Smart Panel US



HDL-MPL8.48-A

Figure 3 - 5. Dimensions



HDL-MPL8.46-A

Figure 6 - 8. Dimensions

Overview

Modern Series DLP Smart Panel EU(US) (See Figure 1-2) is a multi-function control panel for home automation. With 8 control buttons and 2 page buttons, the panel has 4 general pages for lighting, curtains, etc. Dedicated pages are assigned for air conditioning, floor heating and background music playing. According to customers' preferences, icons on LCD display can be changed through programming software.

Functions

- Built-in temperature sensor
- Multi-page control, dedicated page for floor heating, air conditioning, and music control
- Adjustable LCD backlight
- Icon for Key Buttons can be changed by user
- Button combination and Double Button combination function supported
- Button mutual exclusion
- Multi Key modes: Invalid, Single on-off, Single on, Single off, Combination on-off, Combination on, Combination off, Double click/Single on-off, Double click/Combination on-off, Momentary, Clock, Short/long press, Short press/Long momentary press;
- Multi key control types: Scene, Sequence, Timer switch, Universal switch, Single channel on-off, Broadcast scene, Broadcast channel, curtain, GPRS Control, Panel Control, Alarm control, Music play, General control
- Panel control: Lock, Turn on/off AC, Cooling & heating for AC, Auto temperature setting, Fan speed regulating, AC mode setting, AC temperature regulating, Backlight adjusting, AC Lock, Backlight and status indicator light setting, Floor heating temperature and mode setting etc.
- Communication: Upgrading online via HDL Buspro

Important Notes

- The panel should be installed in the wall box.
- The panel should work in conjunction with the power interface.
- It is recommended to connect wires in hand-in-hand.

Product Information

Dimensions - See Figure 3 - 8

1. **LCD screen:** icons and information.
2. **Button indicator:** It is used to indicate the status of the targets. When it is in on-status, the LED indicator on; When it is in off-status, the LED indicator off.
3. **Control button:** It is used to control the status of the targets
4. **Page button:** Turning pages. Pages can be displayed or hidden via programming software.
5. **Communication interface:** It connects to panel power interface.
6. **Mounting slot:** Connects to panel power interface.

Address modification: Keep pressing Button A1 and A8, or Button A2 and A7 to enter the panel setting page. Choose the "SYSTEM", keep pressing the Button A1 or Button A2, you can modify the subnet ID and device ID.

Product installation and disassembly

(Take HDL-MPL8.48-A as an example)

Installation - See Figure 9

- Step 1. Install the wall box in the wall.
- Step 2. Fix the power interface onto the wall box with screws.
- Step 3. Hold the edge of panel, and insert the panel in the slots of power interface vertically.

Disassembly - See Figure 10

- Step 1. Insert a straight screwdriver into the gap between the panel and power interface.
- Step 2. Hold the panel, pry up the panel gently and take down the panel.

Safety Precautions

- The installation and commissioning of the device must be carried out by HDL or the organization designated by HDL. For planning and construction of electric installations, the relevant guidelines, regulations and standards of the respective country are to be considered.
- The device should be wall box mounted. HDL does not take responsibility for all the consequences caused by installation and wire connection that are not in accordance with this document.
- Please do not privately disassemble the device or change components, otherwise it may cause mechanical failure, electric shock, fire or body injury.
- Please resort to our customer service department or designated agencies for maintenance service. The warranty is not applicable for the product fault caused by private disassembly.

Package Contents

HDL-MPL8.48-A or HDL-MPL8.46-A*1 / Datasheet*1

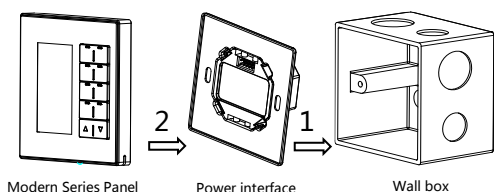

Figure 9. Installation

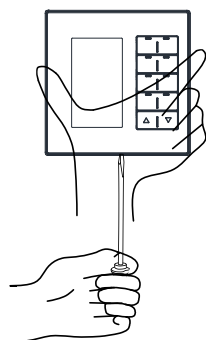

Figure 10. Disassembly

Technical Data

Basic Parameters

Working voltage	12~30V DC
Working current	30mA/24V DC
Communication	HDL Buspro
Cable diameter of Buspro terminal	0.6 - 0.8mm

External Environment

Working temperature	-5°C~45°C
Working relative humidity	≤90%
Storage temperature	-20°C~60°C
Storage relative humidity	≤93%

Specifications

LCD resolution	160x80
Dimensions	HDL-MPL8.48-A : 86×86×10.5(mm) HDL-MPL8.46-A : 86×116.5×10.5(mm)
Net weight	HDL-MPL8.48-A : 109g HDL-MPL8.46-A : 131g
Housing material	Glass, PC, ABS, Aluminum
Installation	Wall box (See Figure 9)
Protection rating (Compliant with EN 60529)	IP20

Name and Content of Hazardous Substances in Products

Components	Hazardous substances					
	Lead (Pb)	Mercury (Hg)	Cadmium (Cd)	Chromium VI (Cr (VI))	Poly-brominated biphenyls (PBB)	Poly-brominated diphenyl ethers (PBDE)
Plastic	o	o	o	o	o	o
Hardware	o	o	o	o	-	-
Screw	o	o	o	x	-	-
Solder	x	o	o	o	-	-
PCB	x	o	o	o	o	o
IC	o	o	o	o	x	x
Glass	o	o	o	o	o	o

The symbol "-" indicates that the hazardous substance is not contained.

The symbol "o" indicates that the content of the hazardous substances in all the homogeneous materials of the component is below the limit requirement specified in the Standard IEC62321-2015.

The symbol "x" indicates that the content of the hazardous substance in at least one of the homogeneous materials of the part exceeds the limit requirement specified in the Standard IEC62321-2015.

HDL Buspro Cable Guide

HDL Buspro	HDL Buspro Cable
DATA+	Yellow
DATA-	White
COM	Black
24V DC	Red

Technical support

E-mail: support@hdlautomation.com

Website: <https://www.hdlautomation.com>

©Copyright by HDL Automation Co., Ltd. All rights reserved.
Specifications subject to change without notice.